

39 38 37 36 35 34 33 32 31 30 29 28 27 26 25 24 23 22 21 20 19 18 17 16 15 14 13 12 11 10 9 8 7 6 5 4 3 2 1 0

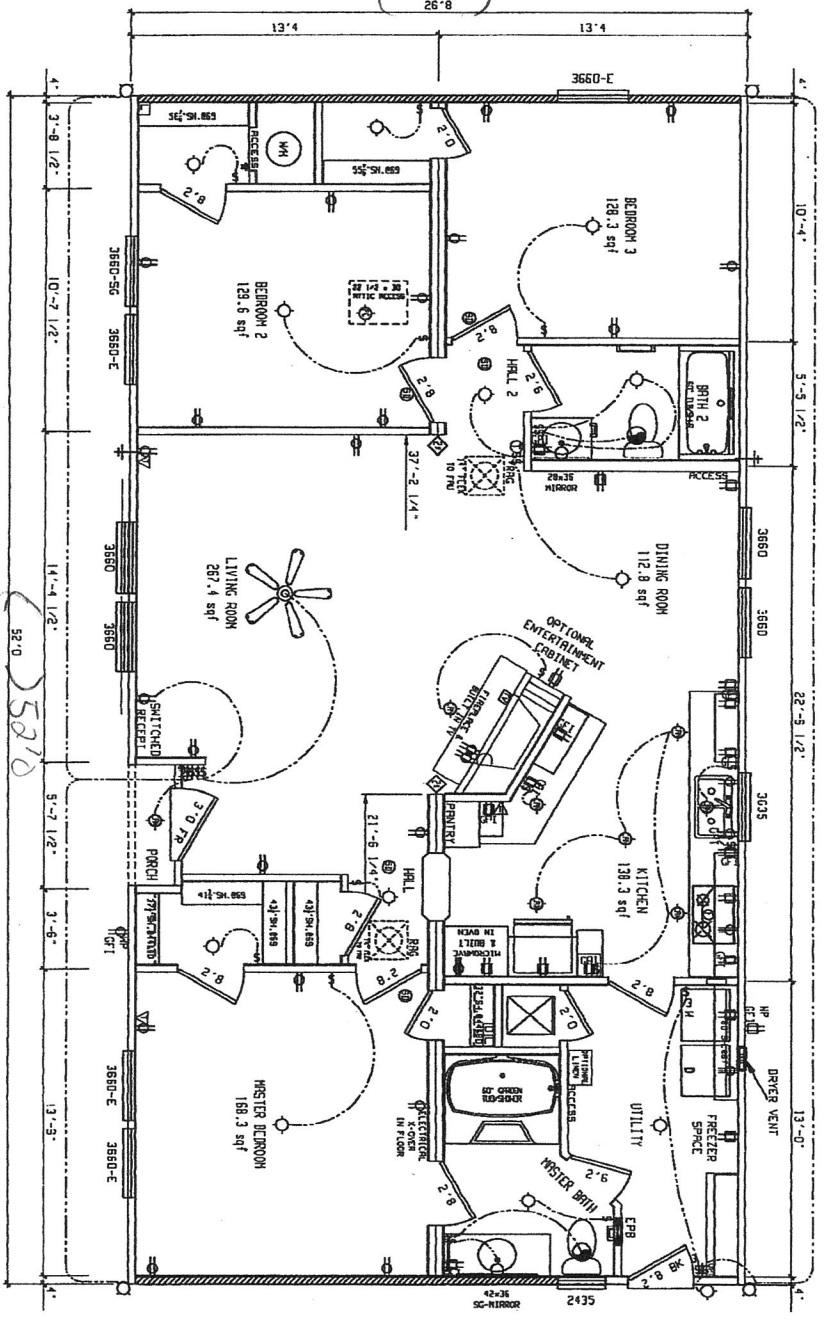

SCOTT HOKES  
P.O. BOX 248-  
304 EAST CHURCH STREET  
RICHFIELD, NC  
OFFICE PH 704-463-7333  
OFFICE FAX 704-222-6178  
E-MAIL: ORSSE@CLAYTON.NET  
TENNESSEE PLAN #SFR-49  
JAMES HERRILL, P. E.  
CLAYTON HOKES INC.  
5000 CLAYTON RD  
HARRISVILLE, TN 37004  
PH: 1-888-380-3000 X 7862  
FAX: 1-888-380-3782

2 ROOF SHEAR DETAILS REFER TO SM2-41.0  
MAX WIND SPEED 130 MPH  
NOTE: IS AVAILABLE WITH 108" CEILING HEIGHT  
OR IS AVAILABLE FLIPPED END TO END OR SIDE TO SIDE

ORKWOOD	SR15	CL28
REVISIONS		
BY	DATE	DESCRIPTION
GENERAL NOTES		
CEILING HEIGHT = 88.00 (0P1) (03.00)		
FLOOR FINISH SPECING = IS		
TOILET WINDOW SPT = 120.52 SINGERS (154.23 OPTIONS)		
DRAWING TITLE		
<b>MASTER PLAN</b>		
NO. F.T.	1385	
MODEL NO.	2932	
DESCRIPTION	3BR-2BR	
DATE PRINTED	02/14/2008	
DATE	01/25/2008	
BY	BLH	

APPROVED BY  
**NPA INC.**  
02/21/2008  
Approval of this document does not authorize or approve any deviation or deviation from the text, spirit or intention of the original design.  
Mike Falter

NO.	DESCRIPTION	REVISIONS REQUIRED
1	20" x 16" CEILING REQUIRED	
2	1" x 10" CEILING w/ 2 1/2" DOOR UNDERCUT	
3	DOOR(S) MUST BE UNDERCUT 2 1/2" MIN.	
4	1" x 2" OR 2" x 4" CEILING REQUIRED	
5	VARIABLES REQUIRED NUMBER OF STUDS IN COLUMN	
6	THE 4 SPECIFICS THAT THESE CMR & NO WALLS IN STUDS IN COLUMNS	